

# Installation Instructions for Vented Disc Brakes\*

Instruction sheet part # 15382 Revised 5/11/06

## Installation Instructions for **TIE DOWN ENGINEERING** Brand Vented Disc Brakes

\* A "DISC BRAKE READY" Actuator must be used with these brakes.

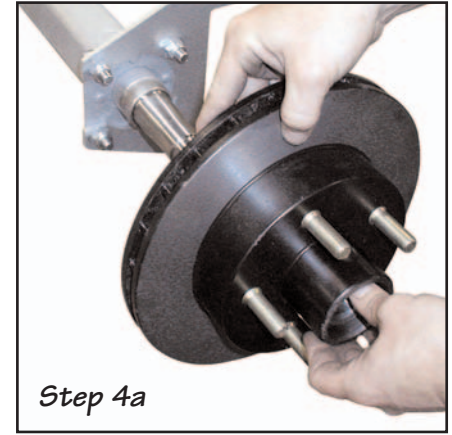

1. On a bare axle attach mounting plate to the brake flanges on the axle. Preferred position is at "12:00" high or to the back side. Exact positioning will be determined by the brake flange. Use 7/16"x1-1/4" zinc hex bolts, lock nuts/washers and torque to 40 lbs.
2. If installation is on a completed trailer, remove tire/wheel. This would be a good time to repack wheel bearings and inspect the bearing and seals if it has not been done recently.
3. Install hub (use existing instruction on installing hubs).
4. Place cap style rotor over hub. Make sure the hub face is clean with a smooth surface or:
- 4a. If installing a integral or "one piece hub rotor", install rear bearing and seal. Grease bearings, install front bearings (use existing instruction on installing hubs).
5. Place caliper over rotor and mounting plate. A bleeder valve must be in the up position. Check both calipers for this position. Some calipers have two valves others have only one.
6. Insert slider pins thru backside of rotor into mounting plate. Use a 7/16" hex socket and tighten both pins to 20 ft. lbs. Check for binding, make sure rotor spins freely.

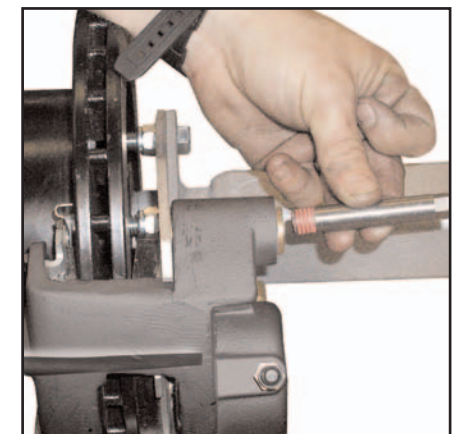
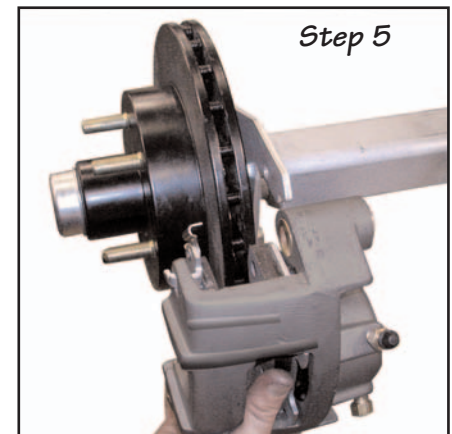

**NOTE: Slider pins have a lock-thread coating. If pins are removed after step 6, the threads must be cleaned and a new coat of "permanent" Lock Tite® must be applied. Apply Lock Tite® to threads in mounting plate. Be careful not to get Lock Tite® on slider pins or bushings**

Instruction #15382

**TIE DOWN ENGINEERING • 5901 Wheaton Drive • Atlanta GA, 30336**  
**www.tiedown.com • (404) 344-0000 • Fax (404) 349-0401**

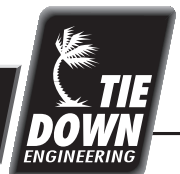

051106, c553

7. Connect brakes lines and bleed brakes before using.

**IMPORTANT:**  
When bleeding calipers, always use the highest bleeder valve to allow air to escape from the caliper piston

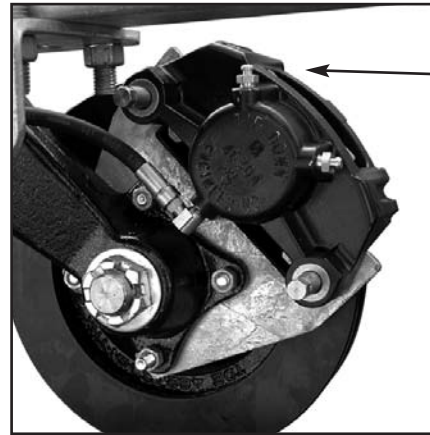

Always bleed through the upper most bleeder valve.

Step 7

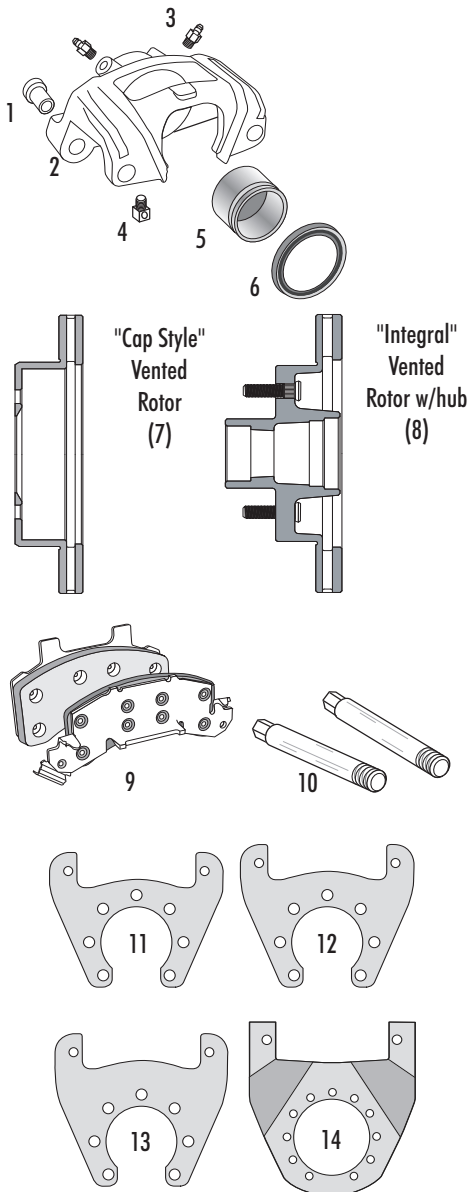

Item	Part #	Description
1	10010	Bronze Bushing
2	46304 46304A	Aluminum disc brake caliper for vented rotor - housing only Aluminum disc brake caliper for vented rotor, includes: 1,3,4,5,6, & 9
3	11246	Brass bleeder valves
4	11242	Inverted flare inlet elbow brake line fitting
5	42080A	Caliper piston, stainless steel/aluminum
6	17472	Rubber boot, caliper
7	46246P	10" Cap style vented rotor, 5 hole, E-Coat finish
7	46246X	10" Cap style vented rotor, 5 hole, GalvX finish
7	46247P	12" Cap style vented rotor, 6 hole, E-Coat finish
7	46247X	12" Cap style vented rotor, 6 hole, GalvX finish
8	46430P	9.6" Integral vented rotor to fit 13" wheels, E-Coat finish
8	46430X	9.6" Integral vented rotor to fit 13" wheels, GalvX finish
8	46245P	10" Integral hub and vented rotor, 5 stud, E-Coat finish
8	46245X	10" Integral hub and vented rotor, 5 stud, GalvX finish
8	46264P	12" Integral hub and vented rotor, 6 stud, E-Coat finish
8	46264X	12" Integral hub and vented rotor, 6 stud, GalvX finish
9	11274 "inside" 11275 "outside"	Brake pads, or use NAPA #TS-7192-M (for 1990 Chevrolet Cavalier) or: IBN #289 and MXD289
10	12114	7/16" Hex head slider pins, stainless steel (2 required)
11	44676G	Mounting bracket for 46430, Integral Rotor for 13" wheels, Galvanized finish
12	44479G	Mounting bracket for 46245 - 10" Integral Rotor, Galvanized finish
13	44480G	Mounting bracket for 46246 - 10" Cap Style Rotor, Galvanized finish
14	44478X	Mounting bracket for 12" Cap or Integral Style Rotor, GalvX finish
These items are available at your local hardware store		Bolts for 10" mounting plate (4) 7/16" x 1-1/4" Grade 5 or better
		Nuts for 10" mounting plate (4) 7/16" nylock nut
		Bolts for 12" mounting plate (5) 3/8" x 1.5" Grade 5
		Nuts for 12" mounting plate (5) 3/8" nylock nut
		Bolts for 12" mounting plate for use with Eliminator 6000# Torsion Axles, tapped for 3/8"-24NF x 3/4"L Bolts Grade 5 or better (5), nuts not required

**TIE DOWN ENGINEERING • 5901 Wheaton Drive • Atlanta GA, 30336**  
**www.tiedown.com • (404) 344-0000 • Fax (404) 349-0401**



051106.c553